

Polk City Trail at The Oasis Detail Plan

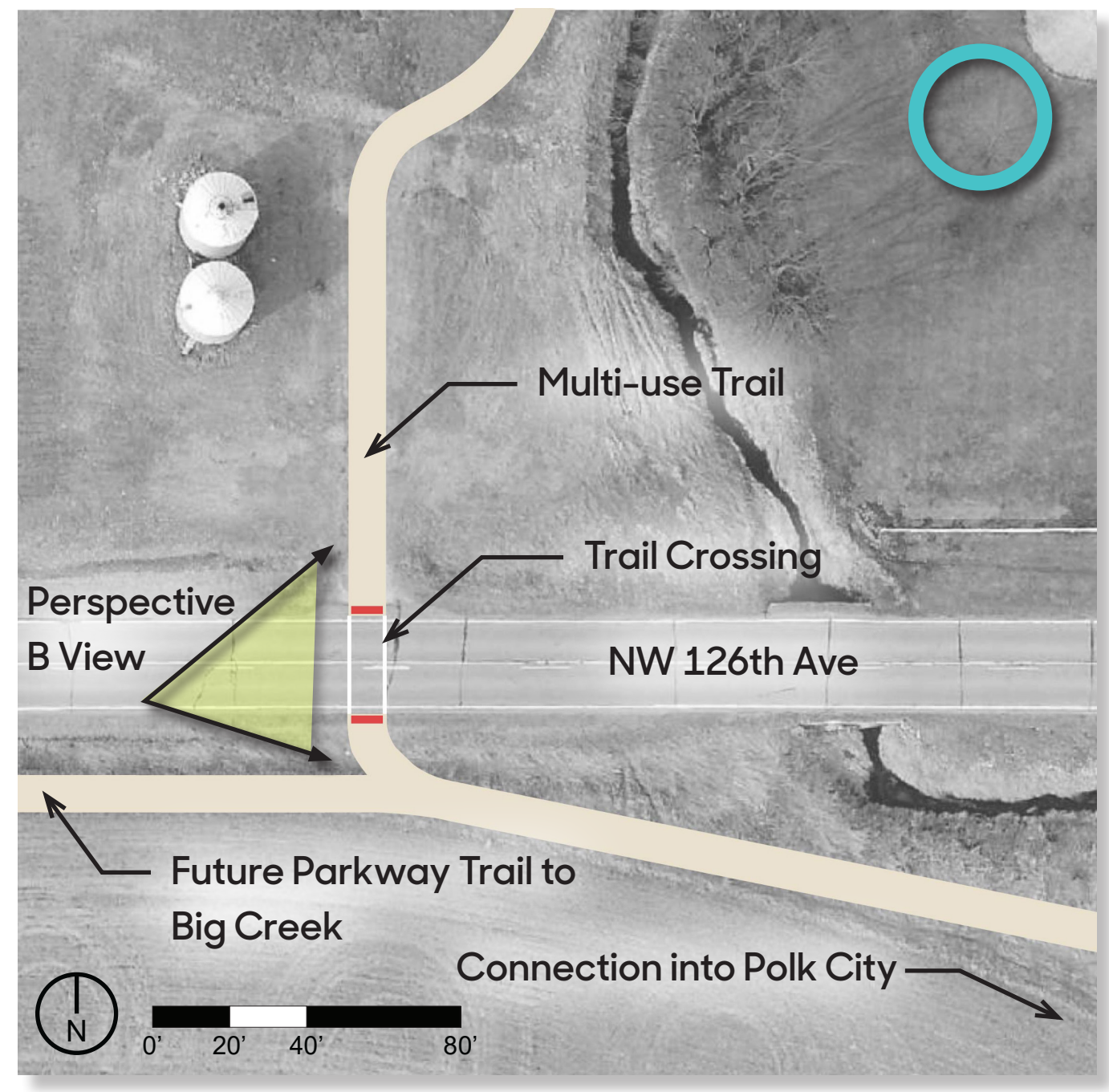

NW 126th Ave Detail Plan



Perspective A: Polk City Trail at Oasis



Broadway and 3rd Axon

Extending the Trails

Polk City is situated near two great regional trails: the Neal Smith Trail and the High Trestle Trail. Currently, the High Trestle Trail bypasses Polk City en route to Ankeny, but with a new extension beginning at The Oasis trail stop,

trail users will have the option to ride into Polk City to access all of its amenities while also giving Polk City residents access to another recreational trail. This trail extension would create an opportunity for another connection

to the Neal Smith Trail if they're heading south on the High Trestle Trail, and would also create an accessible connection to the new Big Creek Technology Campus.



Perspective B: NW 126th Ave



Broadway Section A-A'



3rd St Section B-B'

