

EXTENDING THE TRAILS

Polk City is situated near two regional trails: the Neal Smith Trail and the High Trestle Trail. Currently, the High Trestle Trail bypasses Polk City en route to Ankeny. A new proposed trail extension beginning at The Oasis offers access to the new Technology Campus and the City Square. Additional trail extensions connect directly to the Neal Smith Trail if they're heading south on the High Trestle Trail, and would also create an accessible connection to the new Big Creek Technology Campus.

Additionally, a new trailhead facility is being proposed just west of the City Square across from City Hall. This new facility would offer a much needed stopping point for trail users as well as additional parking for visitors to downtown Polk City. Part of the new trail connectivity system is the incorporation of a 'cycle track' bike lane along 3rd St. which would replace four parallel parking stalls.

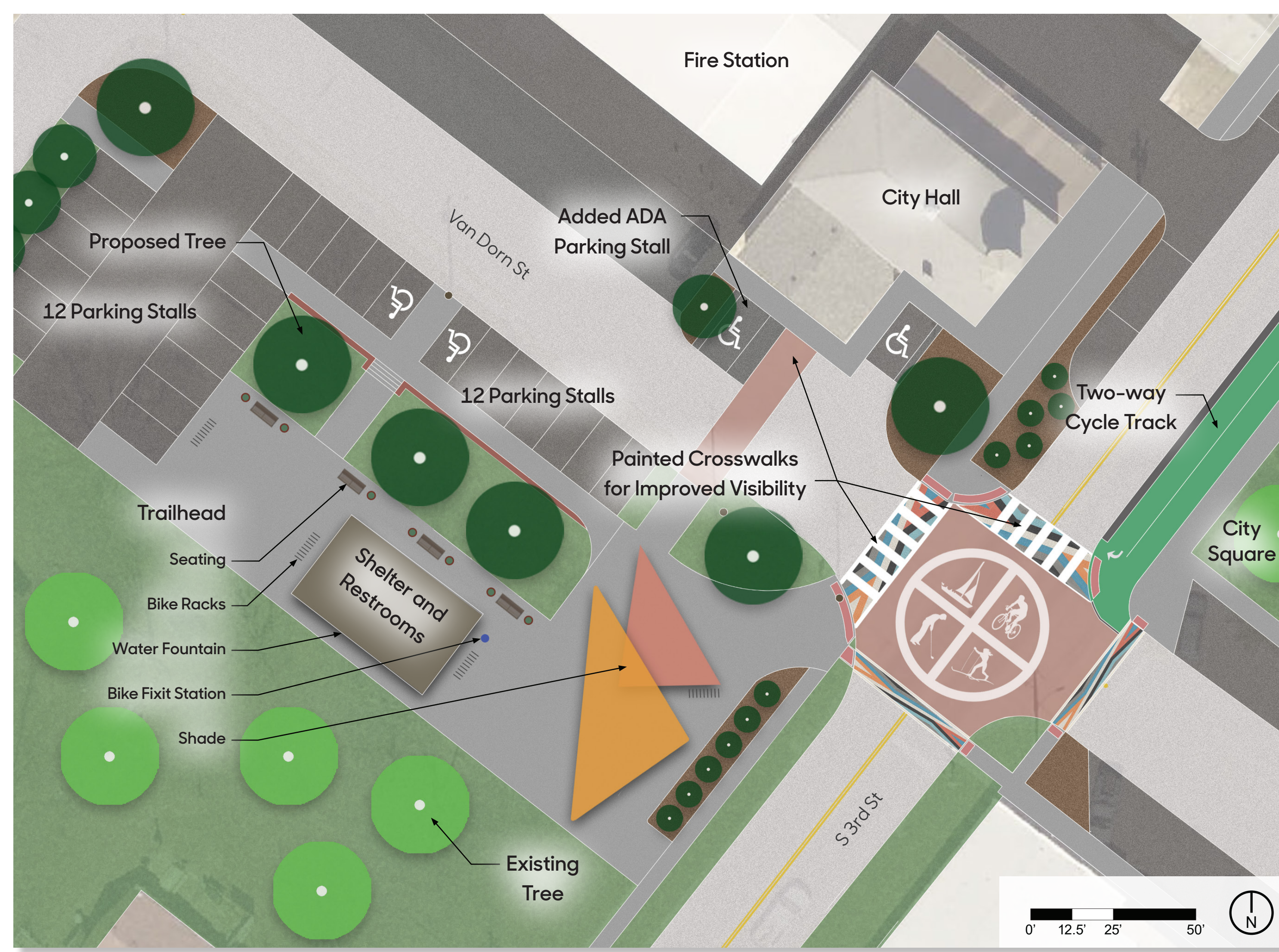
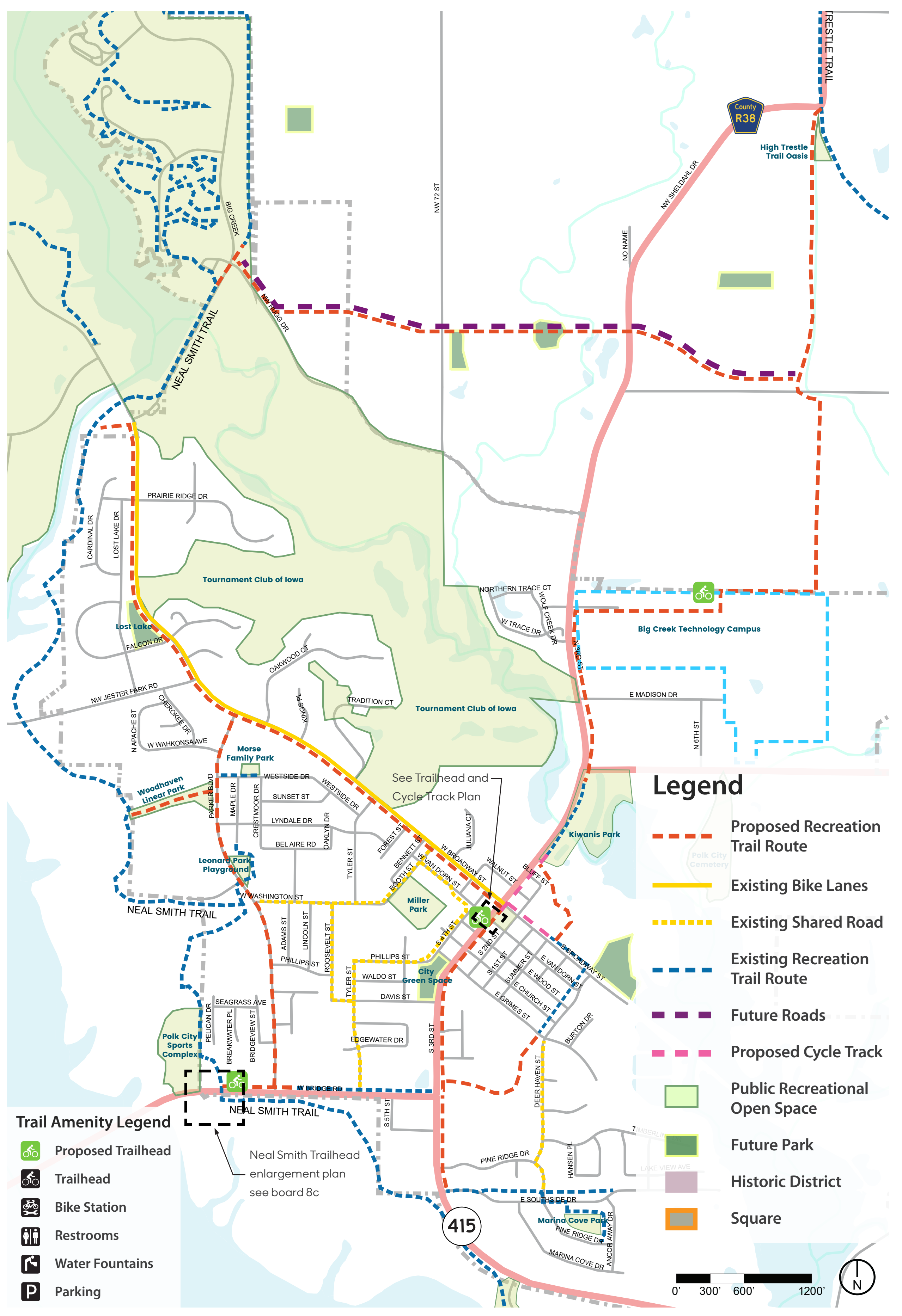

Trailhead and Cycle Track Plan



Trailhead and Cycle Track Perspective

