

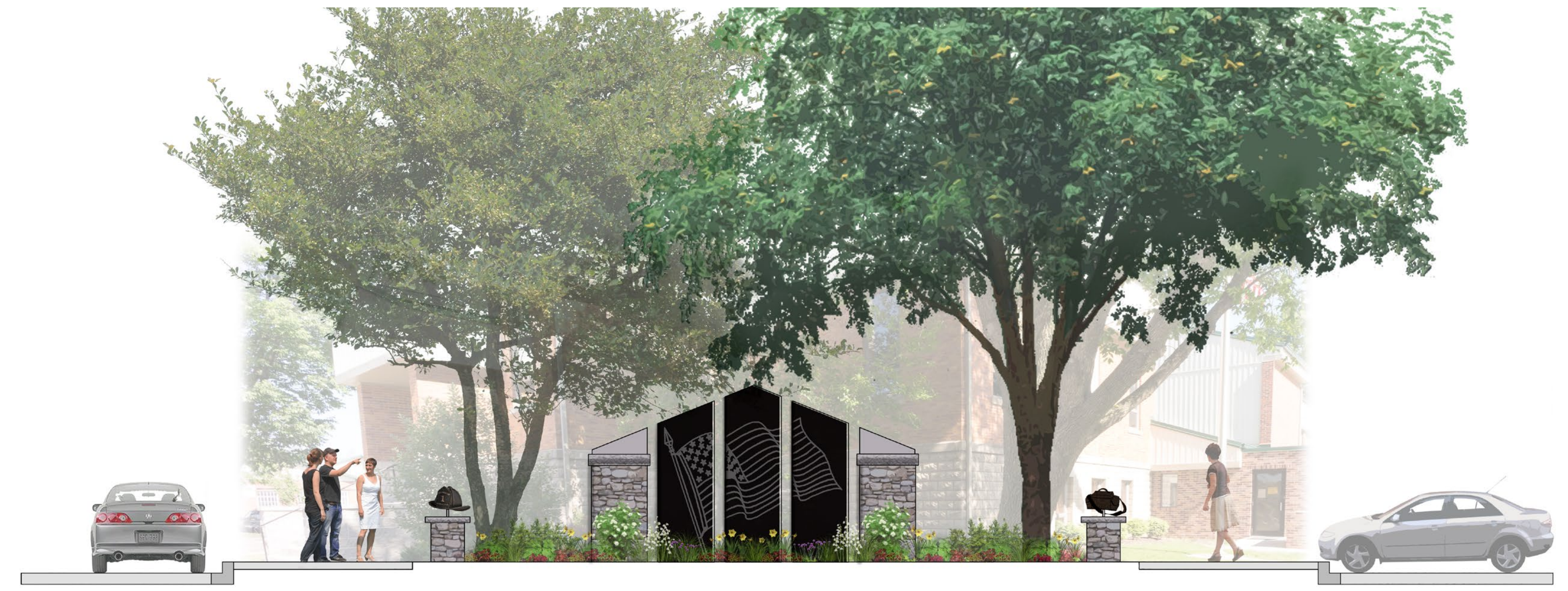

Veterans and Volunteers Memorial Plaza - Concept Plan

- | | | |
|----------------------------------|------------------------------|--------------------------|
| (A) Statue - Fire Dept. Helmet | (E) Granite Bench (Typ.) | (I) Paver Art - EMS Seal |
| (B) Donation Pavers | (F) Veterans Monument | (J) Perennial Plantings |
| (C) Paver Art - Fire Dept. Seal | (G) Colored Concrete Plaza | |
| (D) Paver Art - State of IA Seal | (H) Statue - EMS Medical Bag | |



Veterans and Volunteers Memorial Monument - Elevation View Facing Northwest

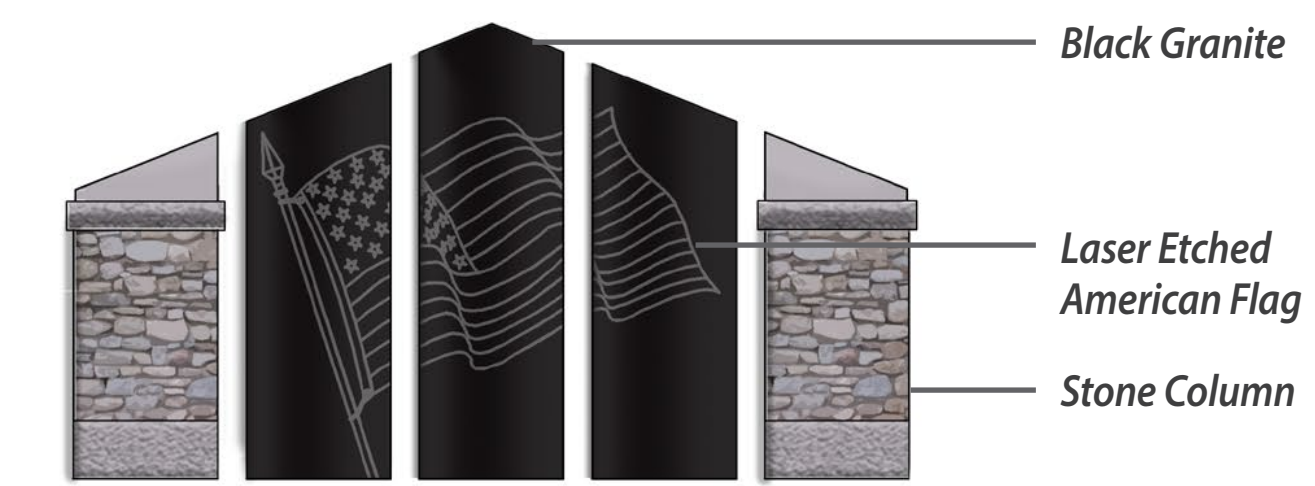

Veterans Memorial Monument - Front

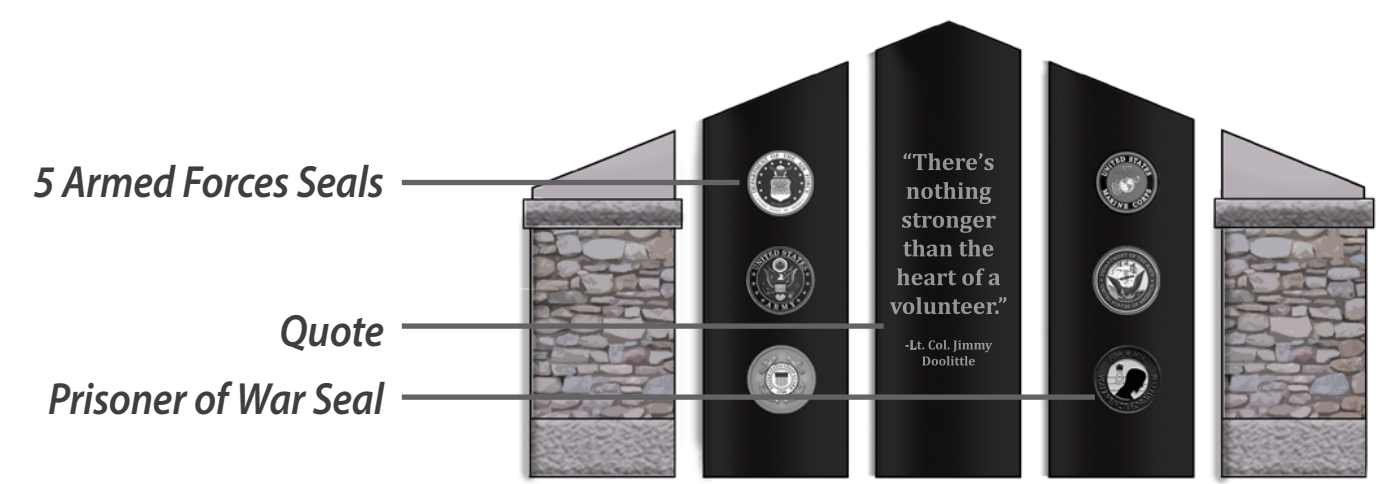

Veterans Memorial Monument - Back

Veterans and Volunteers Memorial Plaza

Residents of Kalona asked the design team to create a memorial plaza to honor those who are serving or have served in any of the five armed forces, including prisoners of war/those missing in action. Community members that are currently serving as volunteers in the emergency medical service (EMS) and fire department are also represented. Groups are honored through statues, paving blocks, and granite monuments.

Guests will be greeted by three foot tall statues signifying the fire department and EMS upon entry. Engraved paving blocks, similar to those seen downtown, will include the seals of these two departments as well as Iowa's state seal. Granite monuments will include an etching of the American flag facing the sidewalks to the southeast and the backside will include six seals surrounding a quote. These features are to be situated on the southeast side of City Hall under the canopies of two existing trees. Impacts to the existing Ash tree should be investigated prior to construction. If the tree is removed, another tree should be planted in its place. The veterans and volunteers memorial will stand as a symbol of the community's appreciation for those who have served.

Kalona

Veterans and Volunteers Memorial Plaza

Landscape Architect: Dylan Jones, PLA, LEED GA - Bolton & Menk

LA Intern: Hannah Schmitz - Bolton & Menk

Iowa Department of Transportation

Trees Forever

ISU Landscape Architecture Extension

ISU Extension Community and Economic Development



Summer 2016