

Proposed East Water Street Trail providing a dedicated connection from the Trout Run Trail at Wold Park to the eastern edge of the downtown area.

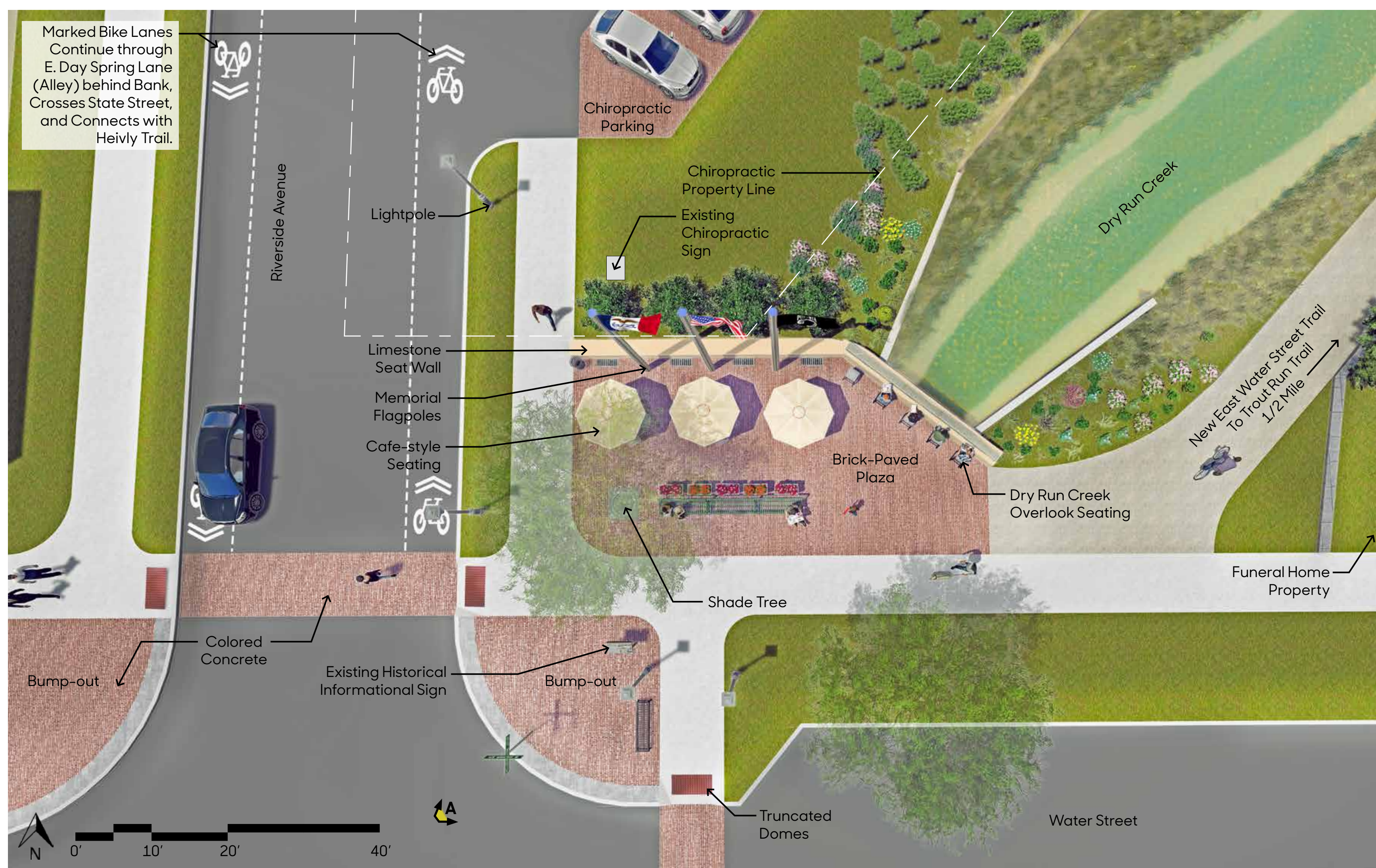

Detailed plan of the proposed Riverside Drive and Water Street plaza space, showing the potential trail connection along Dry Run Creek into downtown.



A: Perspective at Water Street and Riverside Avenue looking northeast showing a new plaza space and access to the East Water Street Trail.

Decorah

East Water Street Trail

Jeffrey L. Bruce and Company LLC

Landscape Architects: Eric Doll, PLA, ASLA and David Stokes, PLA, ASLA
 Interns: Jeremy Johnson and Rosie Manzo

Iowa State University | Trees Forever | Iowa Department of Transportation

