



**Legend**

- Existing sidewalk (solid green line)
- Desired sidewalk (dashed green line)
- Railroad crossing desired improvement (green dashed box)
- Major West town entryway (orange circle with segments)
- Proposed gateway markers (red circle)



Existing Conditions

This image shows the existing condition of Hwy Street at the intersection of South 6th Ave. Although it is a key entryway into the community, the area is currently lacking vegetation, lighting, safe pedestrian connections, and a purposeful vision.

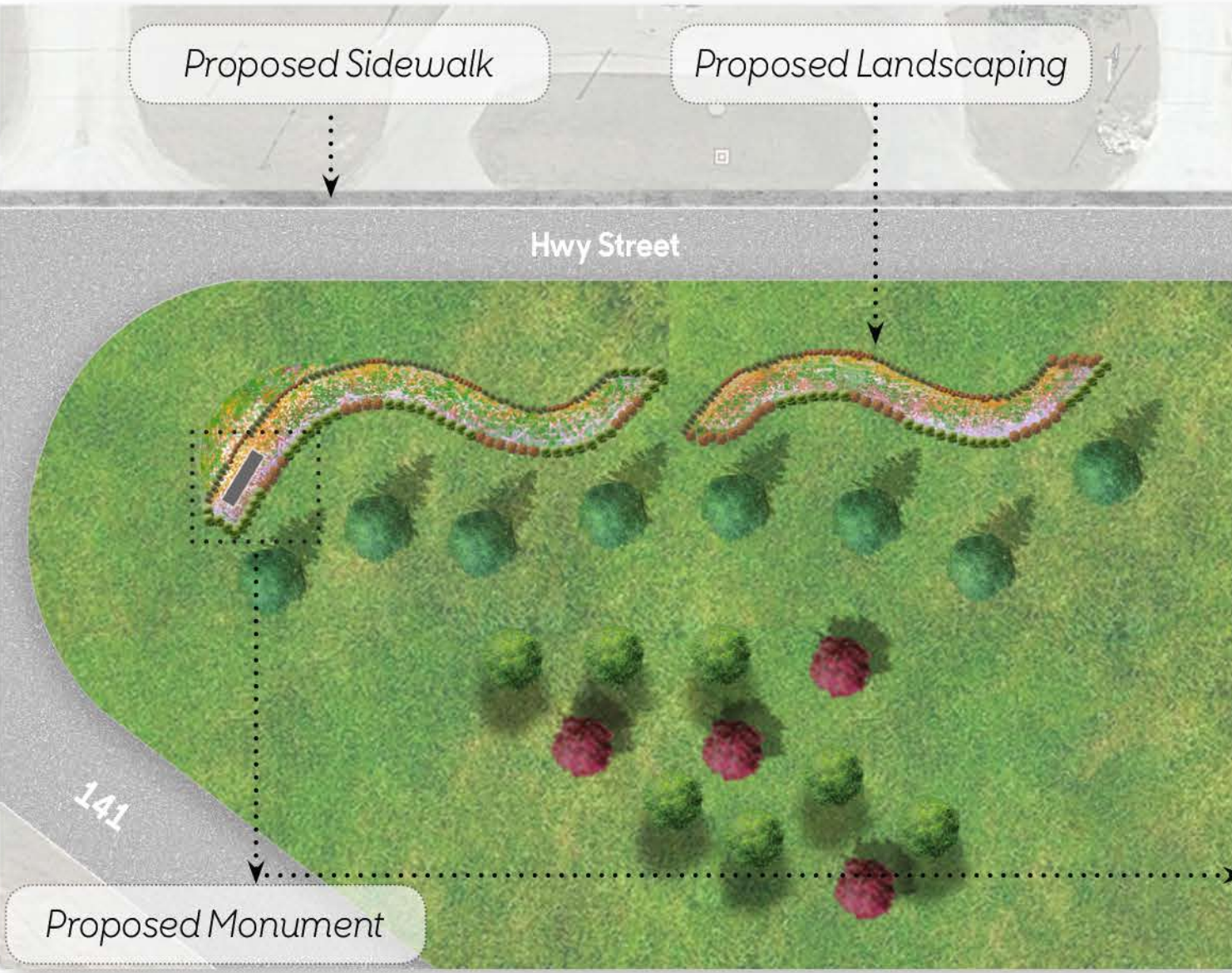

### Hwy St. Arrival Experience Enhancement

This proposed monument would extend the 6th Ave theme to provide continuity and enhance community pride.



Proposed Design

Proposed improvements will liven and enhance the corridor to make the area safer, more vibrant, welcoming, and art-inspired. Incorporating gateway markers will match the character of the entryway at the southern edge of town.

# Coon Rapids Arrival Experience

**Design Team**  
 LA: Casey Byers, PLA; Shannon Gapp  
 Intern: Mahsa Adib  
 Iowa State University | Trees Forever | Iowa Department of Transportation

