

Concept Overview

During the Design Workshop Open House, residents were encouraged to come learn about the Community Visioning process, the analysis that had been done, and what enhancements the Aplington Community Visioning Committee chose during the programming exercise. Residents had an opportunity to review the analysis boards provided by Iowa State University, interact with the design team, and leave feedback on the projects. The open house was an essential part of the process for the design team to better understand and finalize conceptual ideas based on the community's desires.

Many residents of all ages expressed interest in recreational walking and had the opportunity to draw the routes they frequent or wish to utilize safely in the form of a walking trail. From this activity, the design team was able to highlight priority sidewalk improvements and the desired route for a designated walking trail. The creation of the desired walking trail loops on the east and west sides of town correlated with the residents' expressed interest in being able to walk for exercise. These trails could be linked via Gray Street using existing and proposed sidewalks as seen on Pedestrian Connections, board 7.

Developing way-finding signage for Aplington can help residents and visitors find destinations in town, such as the swimming pool or City Park. Additionally, signage can help with "branding" of the community and create a cohesive palette using the same logo and colors for signage.

City Park improvements capitalize on accessibility and circulation. Proposed sidewalks in the park connect to the existing features, providing a smooth paved surface that creates better access for all users.

The proposed safety enhancements are located at two intersections in town, but the safety techniques could be implemented at other troublesome intersections where drivers and pedestrians have identified. Increasing visibility at Parriott Street and 10th Street will make the intersection easier to navigate for both pedestrians and vehicles. Adding pedestrian signage at the intersection alerts oncoming traffic that a pedestrian crossing is present. The Gray and 10th Street intersection has a large amount of undefined pavement and a stop sign that is not located where a driver would easily spot it. Distinguishing the roadway from the parking area by using painted lines and moving the stop sign will aid in creating a more comfortable experience for all.

Aplington

Concept Overview



Comments from residents during the Design Workshop about what they would like to see in Aplington

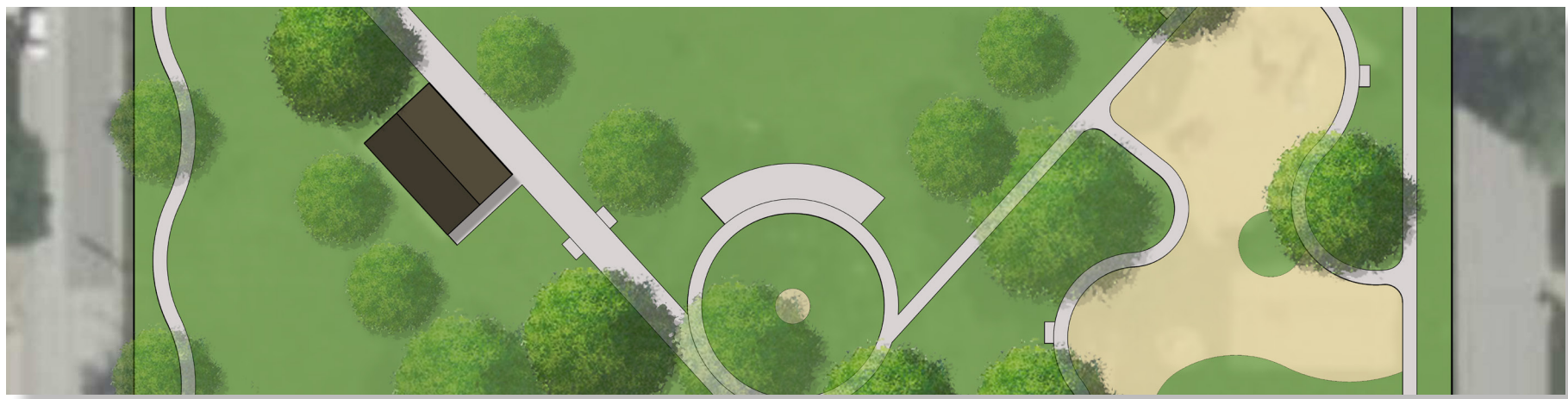

City Park Improvements, board 9

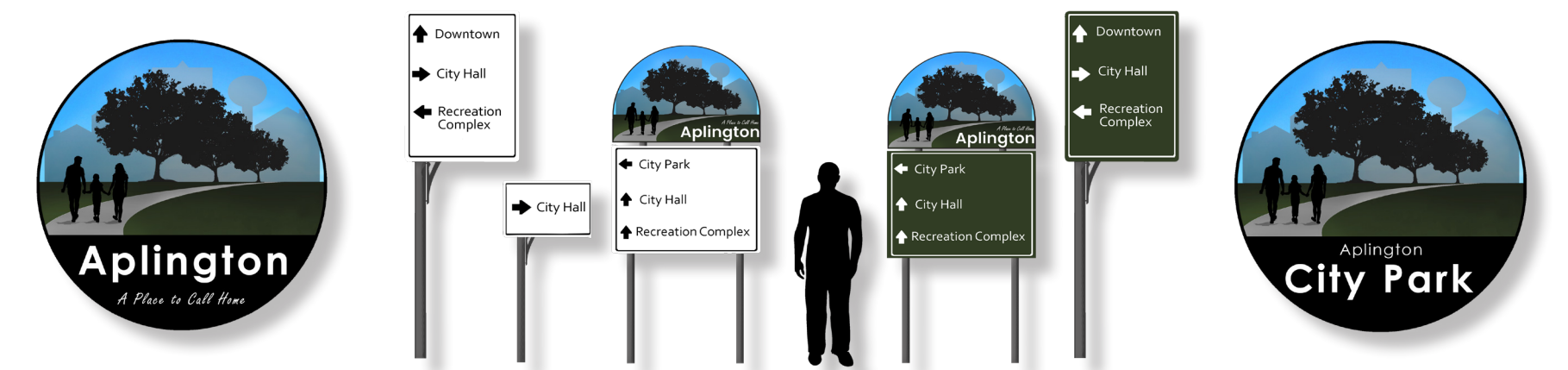

Way-finding & Signage, board 8



Pedestrian Connections, board 7

RITLAND+KUIPER Landscape Architects

Landscape Architects: Craig Ritland, FASLA, & Samantha Price, ASLA

Intern: Amber Pearce

Iowa State University | Trees Forever | Iowa Department of Transportation

